

Bulletin No.	TS82-011A
Date	March 7, 1982
Classification	ST82-001A
Section	Steering
Models	Maxima, 280ZX

STEERING GEAR (RP 15L AND 1PRP15L)

Applied Model: 910 and S130 Series

Applied From: 910 Series HLG910-009818
 SLG910-000001
 WHLD910-004306
 WHLD910-004653 (Retainer Spring)
 WSLD910-000001
 WSLD910-000027 (Retainer Spring)

S130 Series HS130-228434
 HGS130-169606

Modification Notice

1. The lock plate has been redesigned and the length of the rack has been changed. Also a bonding agent has been applied to the threaded portion of the side rod inner socket. (910: IPRP15L)

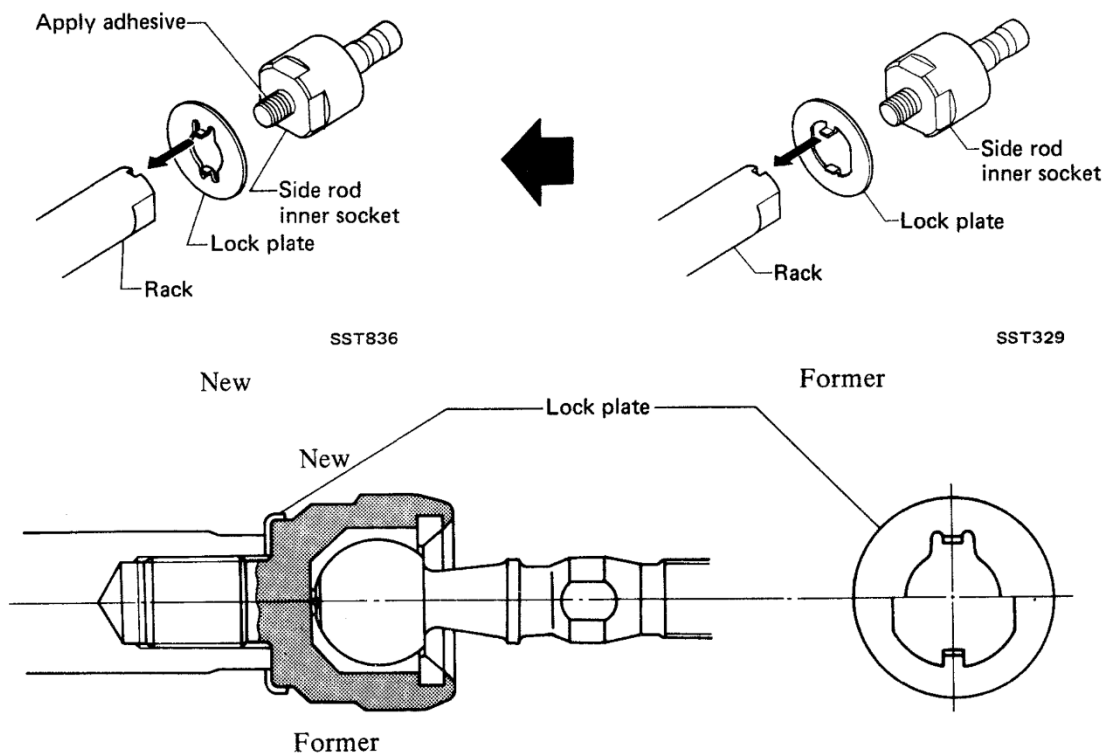

Continued

2. The retainer adjusting screw has been redesigned.
 (910, S130: IPRP15L) S130: IPRP15L)

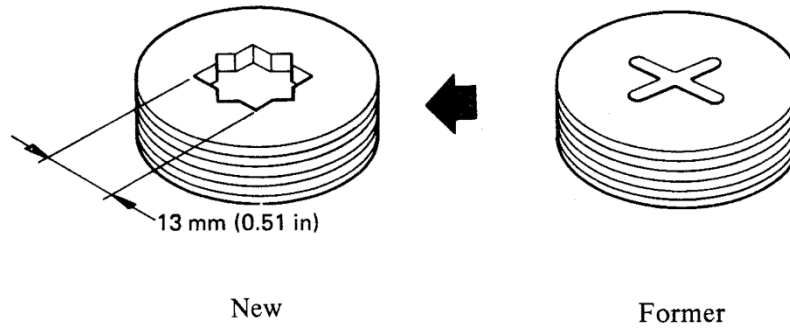

Power Steering Gear

Rack Starting Force of power steering from the neutral position has been increased as follows.

	Rack Starting Force (Kg)	
	New	Former
Power Steering	12.5—19.0	9.0—15.0

Part number of retainer spring, power steering.

Power Steering	Part No.	48237-W1000	48237-W1400
	Setting Spring Tention	19.4 Kg	8 Kg

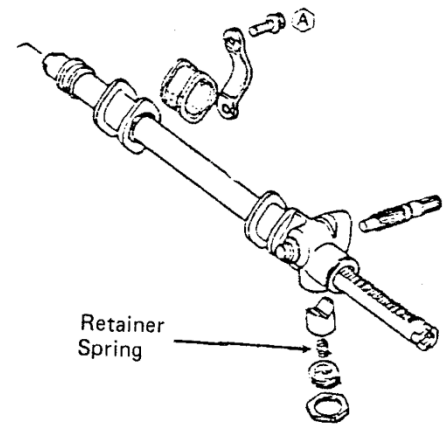

Applied production month: (1) Power Steering : September, 1981

Continued

Parts Affected:

The parts affected by this change are as follows.

Part Name	New Part Number	Available from	Former Part Number	Applied Model
Gear & Linkage Assy-Steering	49001-W2402	Any Time	49001-W2401	910: IPRP15L
	49001-P9001			S130: IPRP15L
Rack-Steering Gear	48100-D1200		48100-W2200	910: RP15L
Plate-Lock	48635-D0100		48635-W1410	910: IPRP15L
Screw-Adjust Retainer	48231-D0300		48231-W1000	910: IPRP15L S130: IPRP15L
Spring-Retainer	48237-W1002	Any Time	48237-W1000	910
	48237-78500		48237-P6500	S130
Shim-Adjusting	48238-E4100		—	910

Interchangeability:

Rack-Steering Gear	} Yes, as a set of these parts.
Plate-Lock	
Screw-Adjust Retainer	Yes
Spring-Retainer	Yes
Shim-Adjusting	Yes